

PART NUMBER DESCRIPTION

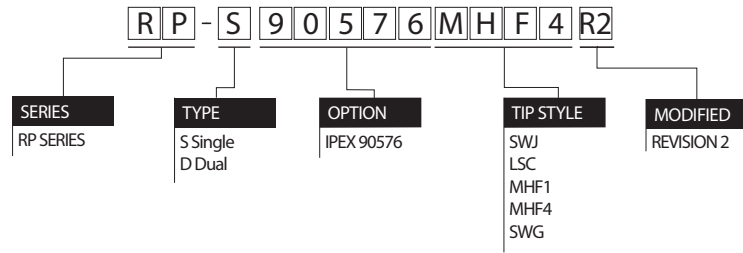

MATERIAL AND FINISH

	MATERIAL	FINISH
CENTER CONTACT	BERYLLIUM COPPER	10μ" GOLD
INSULATOR	PTFE	WHITE
OUTER CONTACT	BERYLLIUM COPPER	10μ" GOLD
	BRASS	GOLD
SPRING	SWPB	GOLD
	SW80C	NONE

MECHANICAL

	TEST CONDITION	SPECIFICATIONS
FORCE TO ENGAGE	N/A	19 N Max (SMPM)
FORCE TO DISENGAGE	N/A	29 N Max(SMPM)
CONTACT RETENTION	60mm/min	7 N Mn (SMPM)
MAXIMUM COMPRESSION	N/A	1.2 mm
RECOMMENDED COMPRESSION	N/A	0.8 - 1.0 mm
AXIAL MISALIGNMENT	N/A	Please refer to next page

ELECTRICAL

	TEST CONDITION	SPECIFICATIONS
IMPEDANCE	DC~6 GHz	50 Ohms
VSWR	DC~3 GHz	1.3 Max
VSWR	DC~6 GHz	1.5 Max
VSWR	DC ~ 10GHz	1.8 Max
DIELECTRIC WITHSTANDING VOLTAGE	DC , Time : 60s	300 Vrms Min
CENTER CONTACT RESISTANCE	DC 0.2V , 1A	50 mΩ
OUTER CONTACT RESISTANCE	DC 0.2V , 1A	10 mΩ
INSULATING RESISTANCE	DC 500V , Time : 60s	500 MΩ



RAPIDTEK
RF PROBE

STANDARD DIMENSIONS

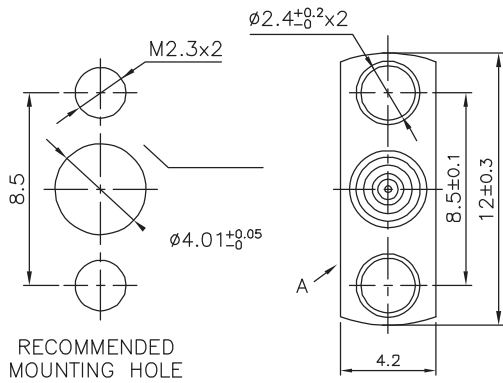

RECOMMENDED MOUNTING HOLE

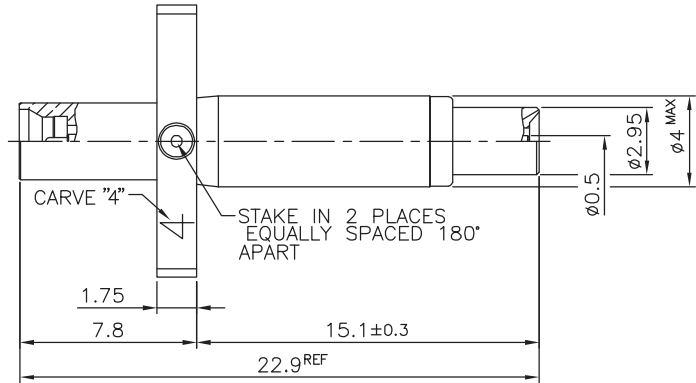

REMARK : 1. SPRING COMPRESSION DIMENSION IS 1.2mm Max.

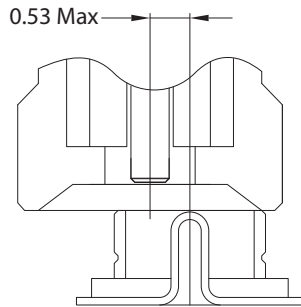
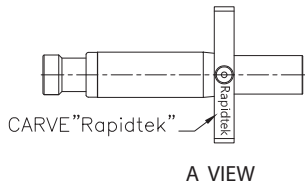

AXIAL HORIZONTAL MISALIGNMENT DISTANCES

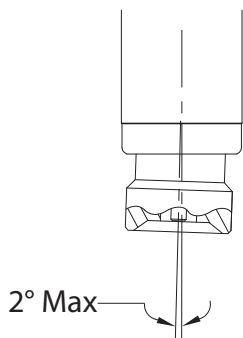

AXIAL VERTICAL MISALIGNMENT ANGLE

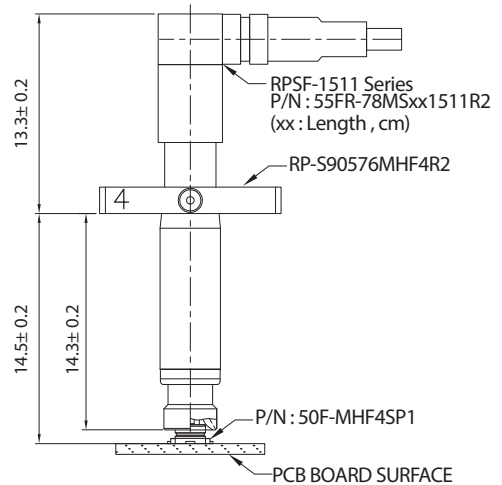
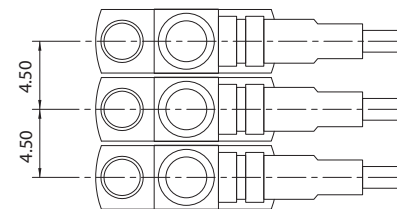

RECOMMENDED LOAD POSITION

RP-S90576MHF4R2



**RAPIDTEK
RF PROBE**

TEST REPORT

Lab Environmental Condition :

Temperature : 25±5°C

Relative Humidity : ≤ 50 % RH

Test Method : Compression 1.0mm ± 0.1mm

Test Equipment :

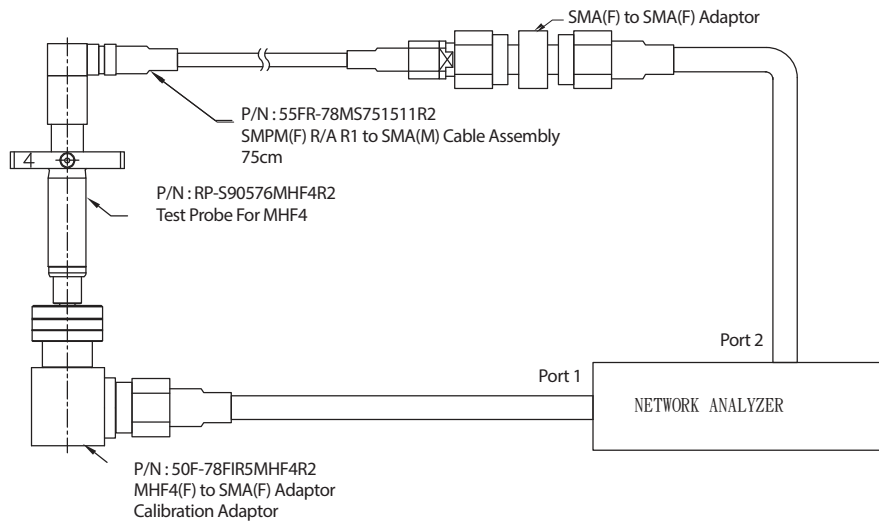

Result :

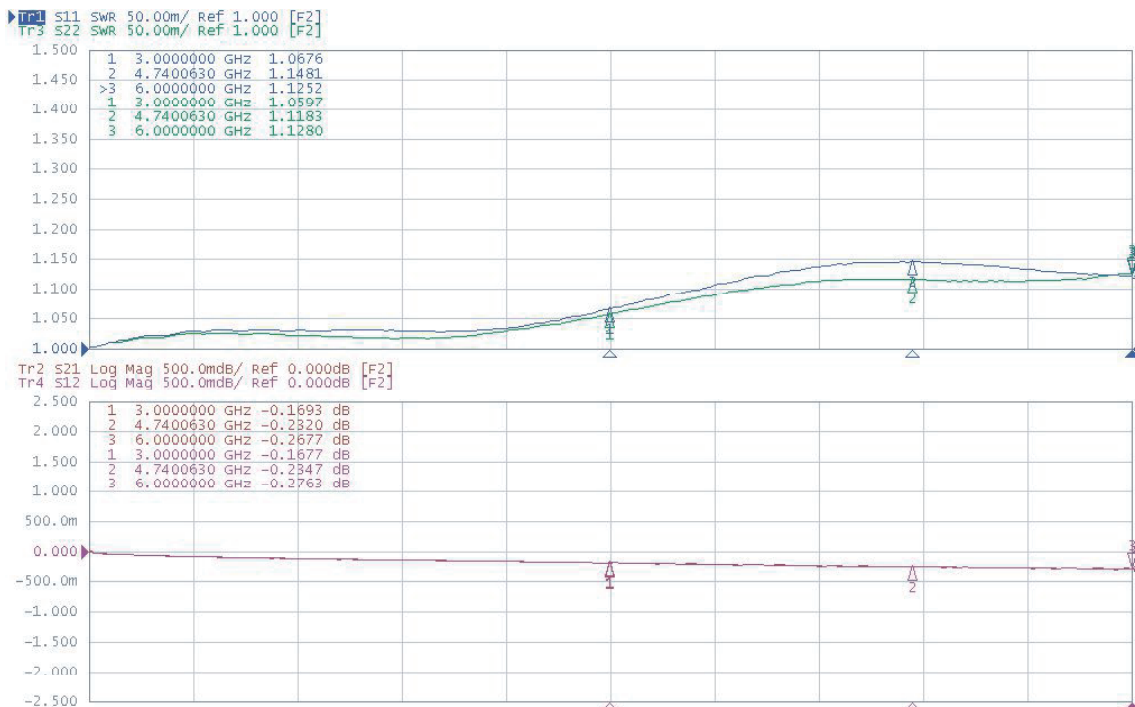

RAPIDTEK
RF PROBE

LIFE REPORT

Lab Environmental Condition :

Temperature : 25±5°C

Relative Humidity : ≤50 % RH

Test Specification : 12 Times / Minute

Test Method : Compression 1.0mm ± 0.1mm

Durability : 12,000 cycles



Insert & Withdrawal Equipment

Result :

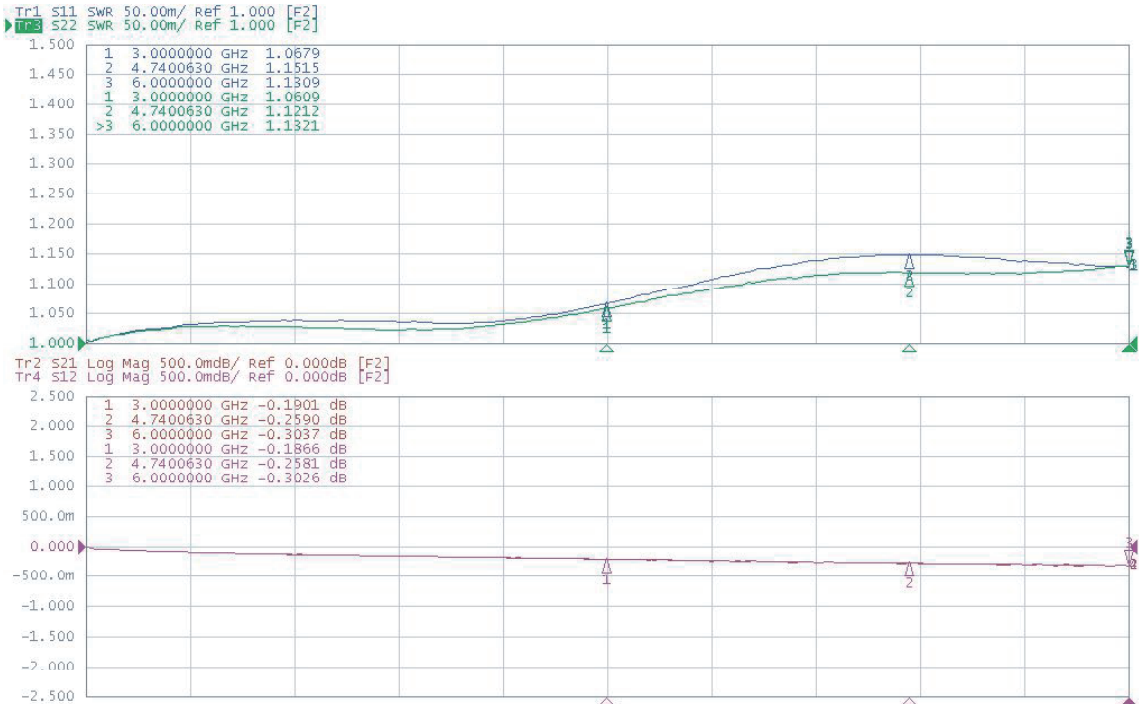

RAPIDTEK
RF PROBE

TEST REPORT

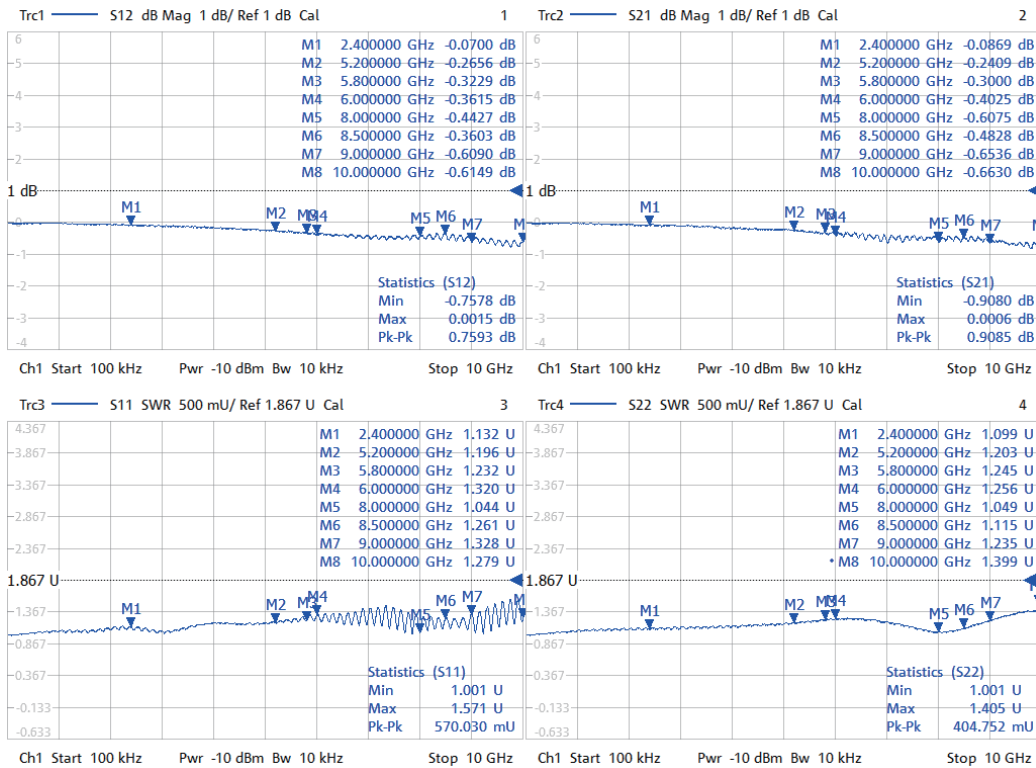

RP-S90576MHF4R2--UP TO 10GHz



RAPIDTEK
RF PROBE