

PART NUMBER DESCRIPTION

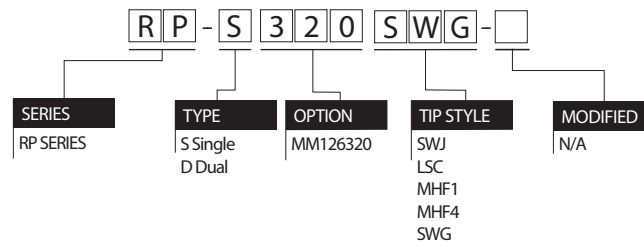

MATERIAL AND FINISH

	MATERIAL	FINISH
CENTER CONTACT	BERYLLIUM COPPER / BRASS	10μ"/30μ" GOLD
INSULATOR	PTFE	WHITE
OUTER CONTACT	STAINLESS STEEL	PASSIVATED
	BRASS	70μ" NICKEL
PANEL	STAINLESS STEEL	PASSIVATED
SPRING	SWPB	GOLD
	SW80C	70μ" NICKEL

MECHANICAL

	TEST CONDITION	SPECIFICATIONS
FORCE TO ENGAGE	N/A	2 in-lbs Max (SMA)
FORCE TO DISENGAGE	N/A	2 in-lbs Max (SMA)
CONTACT RETENTION	60mm/min	6 lbs Min (SMA)
DURABILITY	12 times /min	1M cycles min.

ELECTRICAL

	TEST CONDITION	SPECIFICATIONS
IMPEDANCE	DC ~ 6 GHz	50 Ohms
VSWR	DC ~ 3 GHz	1.6 Max
	DC ~ 6 GHz	1.7 Max
	DC ~ 7.5 GHz	1.75 Max
	DC ~ 11 GHz	2.1 Max



STANDARD DIMENSIONS

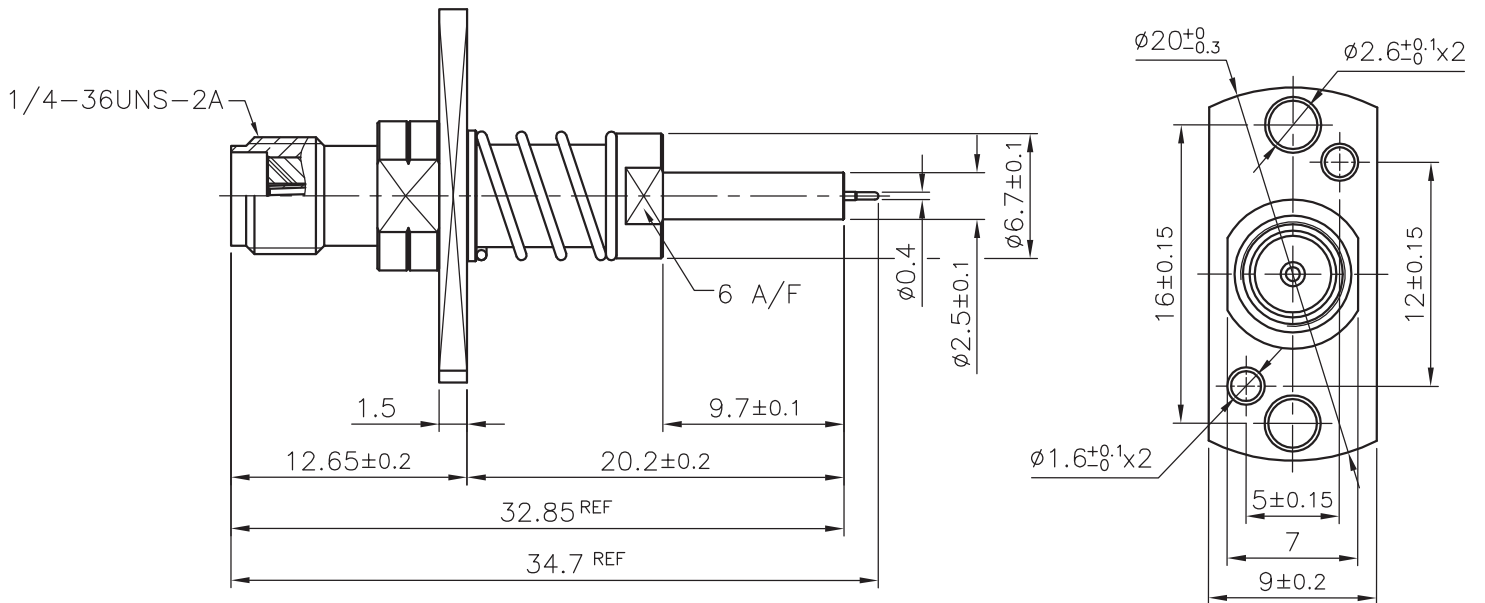

RP-S320SWG

REMARK: 1. SPRING COMPRESSION DIMENSION IS 20 mm Max. USING AREA 18.2mm To 20.0 mm

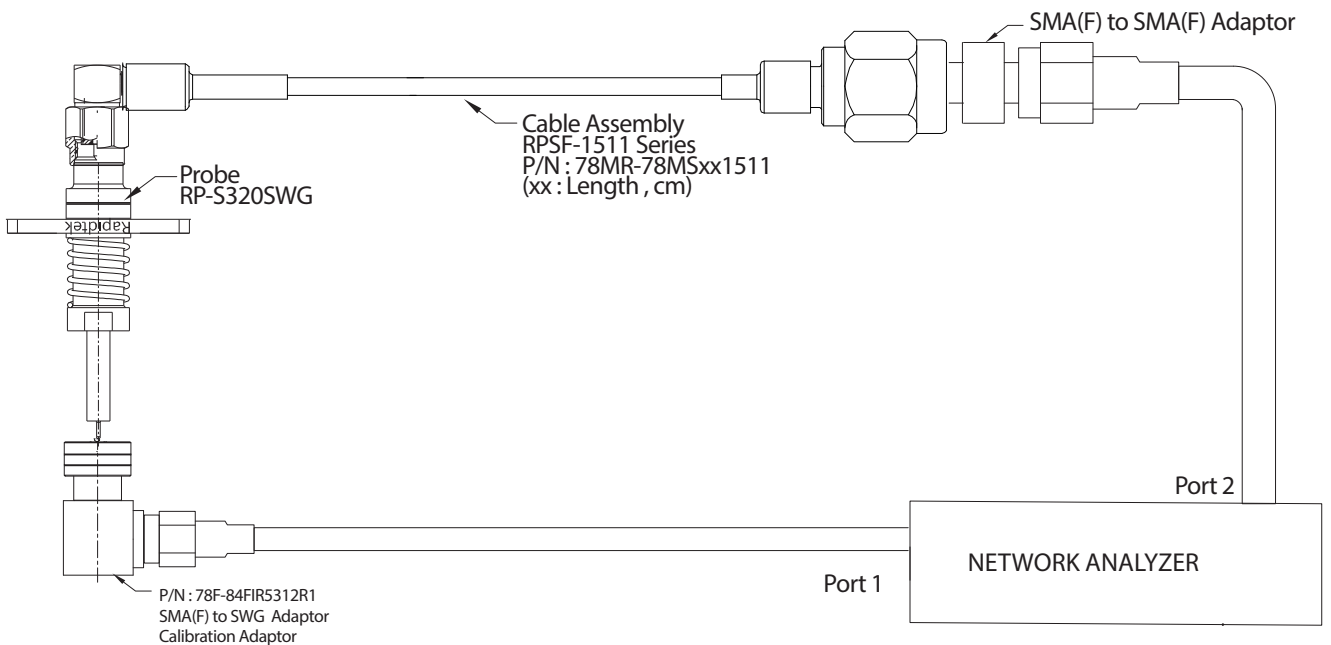

RAPIDTEK
RF PROBE

TEST REPORT

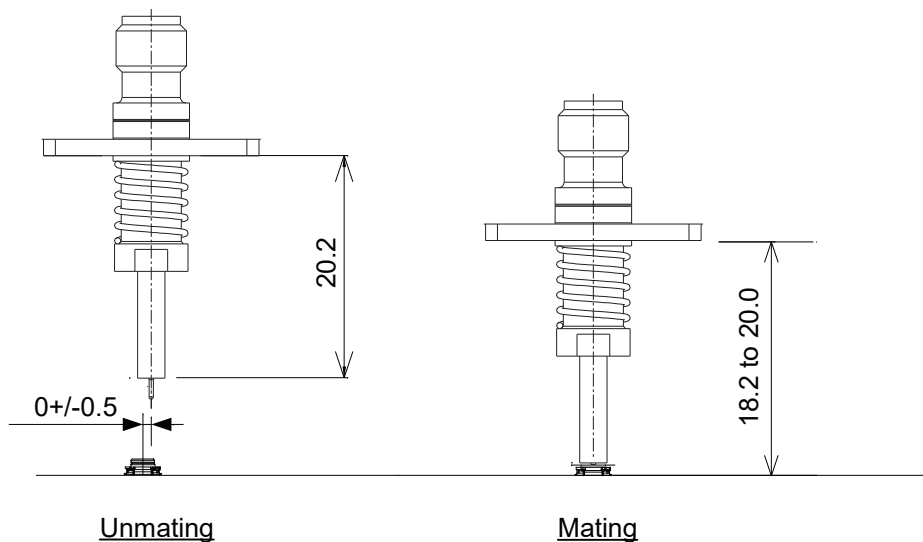

Unit:mm

AXIAL HORIZONTAL MISALIGNMENT DISTANCES

SPRING COMPRESSION DIMENSION IS 2.0mm Max.

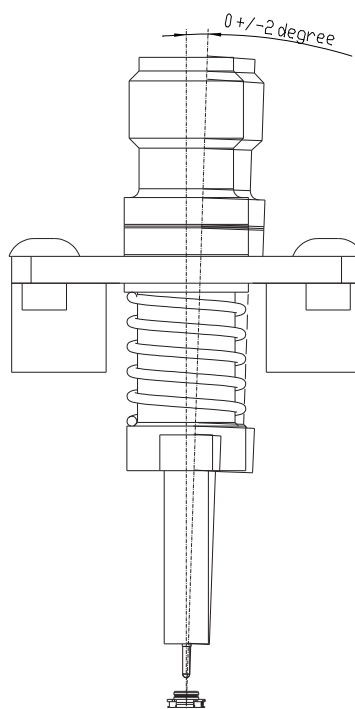

AXIAL VERTICAL MISALIGNMENT ANGLE



RAPIDTEK
RF PROBE

TEST REPORT

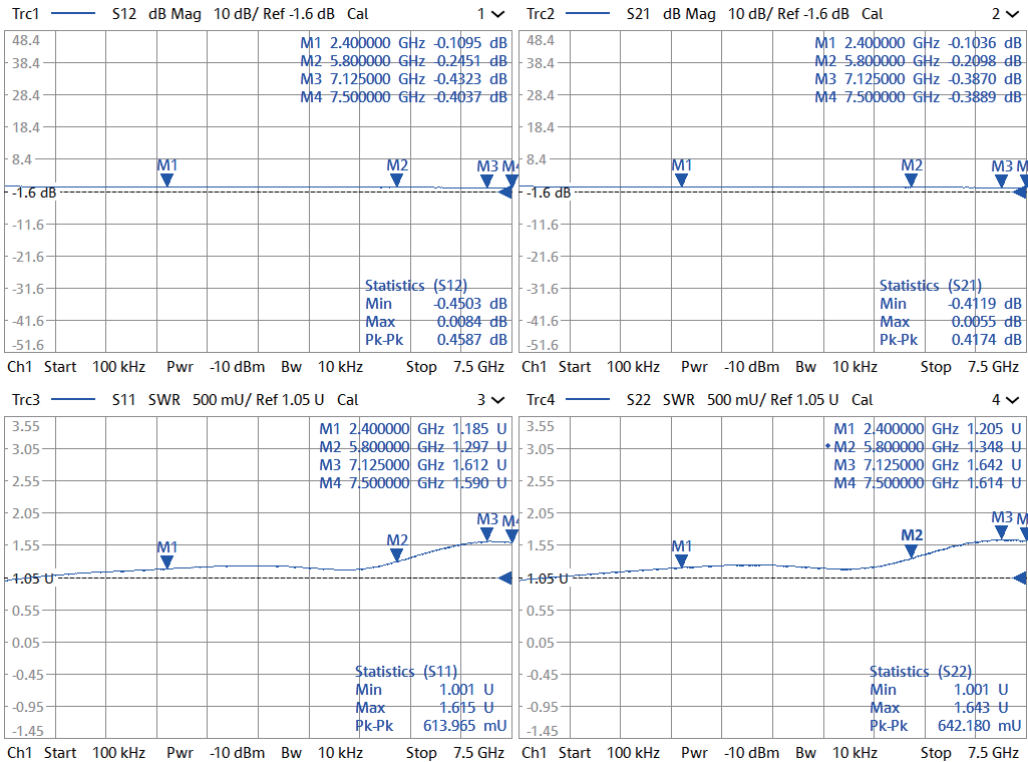

Probe RP-S320SWG With Calibration Adaptor 78F-84FIR5312R1



RAPIDTEK
RF COAXIAL PROBE