

**PART NUMBER DESCRIPTION**

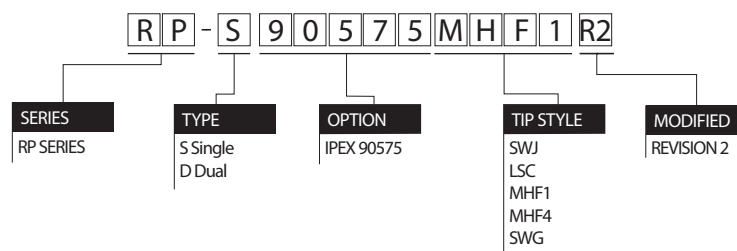

**MATERIAL AND FINISH**

	MATERIAL	FINISH
CENTER CONTACT	BERYLLIUM COPPER	10μ" GOLD
INSULATOR	PTFE	WHITE
OUTER CONTACT	BERYLLIUM COPPER	10μ" GOLD
	BRASS	GOLD
SPRING	SWPB	GOLD
	SW80C	NONE

**MECHANICAL**

	TEST CONDITION	SPECIFICATIONS
FORCE TO ENGAGE	N/A	19 N Max (SMPM)
FORCE TO DISENGAGE	N/A	29 N Max(SMPM)
CONTACT RETENTION	60mm/min	7 N Mn (SMPM)
MAXIMUM COMPRESSION	N/A	1.2 mm
RECOMMENDED COMPRESSION	N/A	0.8 - 1.0 mm
AXIAL MISALIGNMENT	N/A	Please refer to next page

**ELECTRICAL**

	TEST CONDITION	SPECIFICATIONS
IMPEDANCE	DC~6GHz	50 Ohms
VSWR	DC~3GHz	1.3 Max
VSWR	DC~6GHz	1.5 Max
DIELECTRIC WITHSTANDING VOLTAGE	DC, Time : 60s	300 Vrms Min
CENTER CONTACT RESISTANCE	DC 0.2V, 1A	50 mΩ
OUTER CONTACT RESISTANCE	DC 0.2V, 1A	10 mΩ
INSULATING RESISTANCE	DC 500V, Time : 60s	500 MΩ



**RAPIDTEK**  
**RF PROBE**

**STANDARD DIMENSIONS**

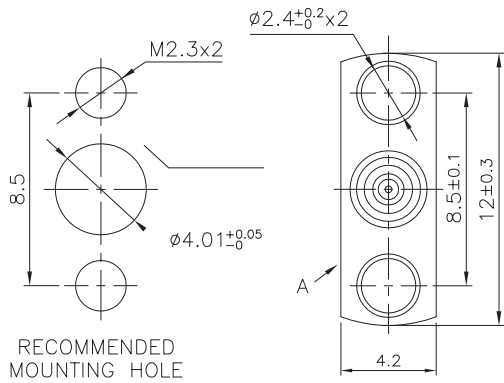

RECOMMENDED MOUNTING HOLE

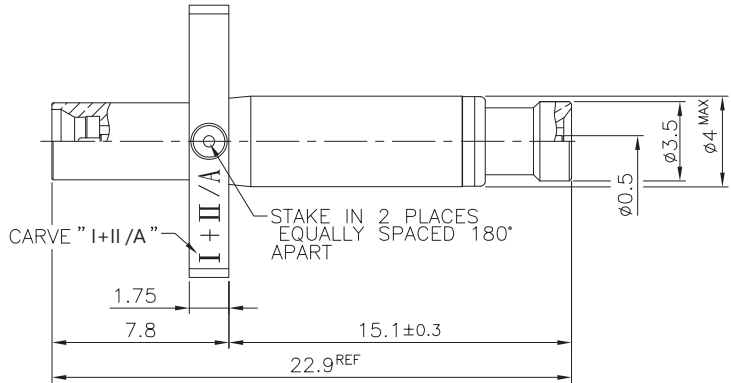

REMARK : 1. SPRING COMPRESSION DIMENSION IS 1.2mm Max.

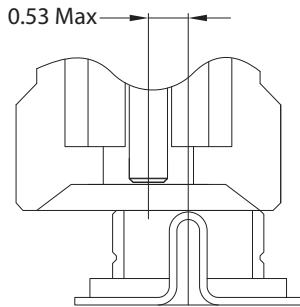
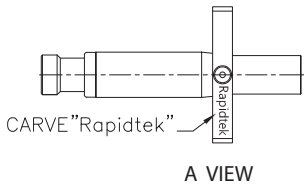

AXIAL HORIZONTAL MISALIGNMENT DISTANCES

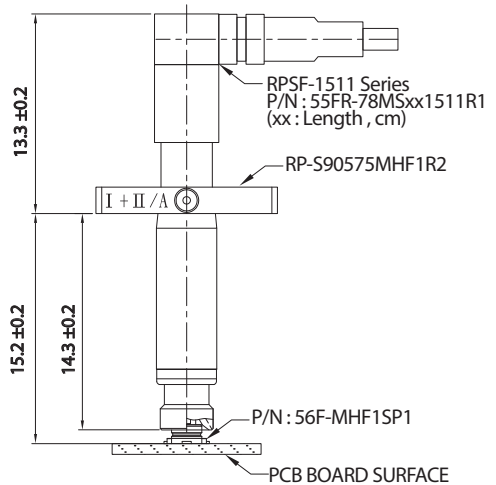
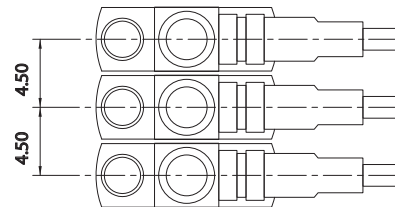

RECOMMENDED LOAD POSITION

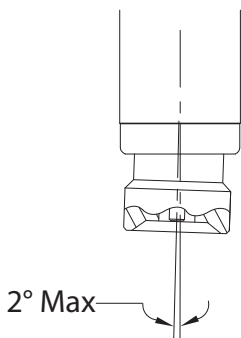

AXIAL VERTICAL MISALIGNMENT ANGLE

**RP-S90575MHF1R2**



**RAPIDTEK**  
**RF PROBE**

**TEST REPORT**

**Lab Environmental Condition :**

Temperature : 25±5°C

Relative Humidity : ≤ 50 % RH

Test Method : Compression 1.0mm ± 0.1mm

**Test Equipment :**

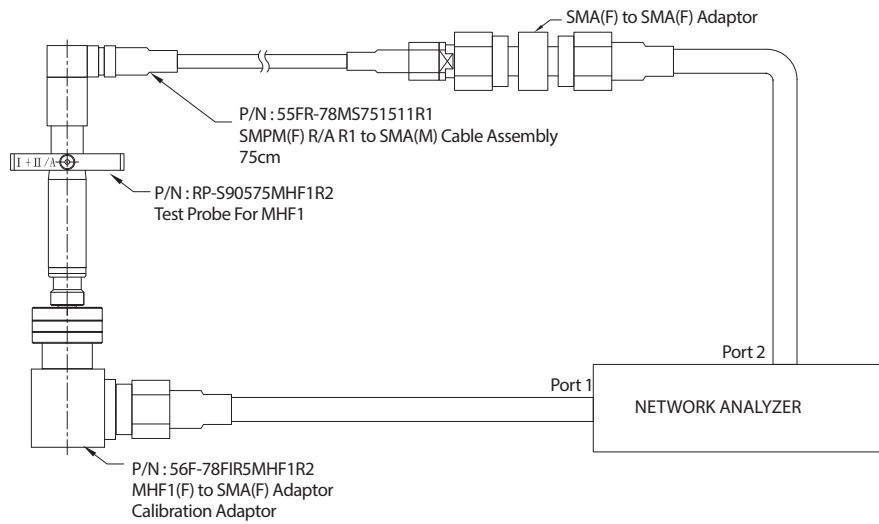

**Result :**

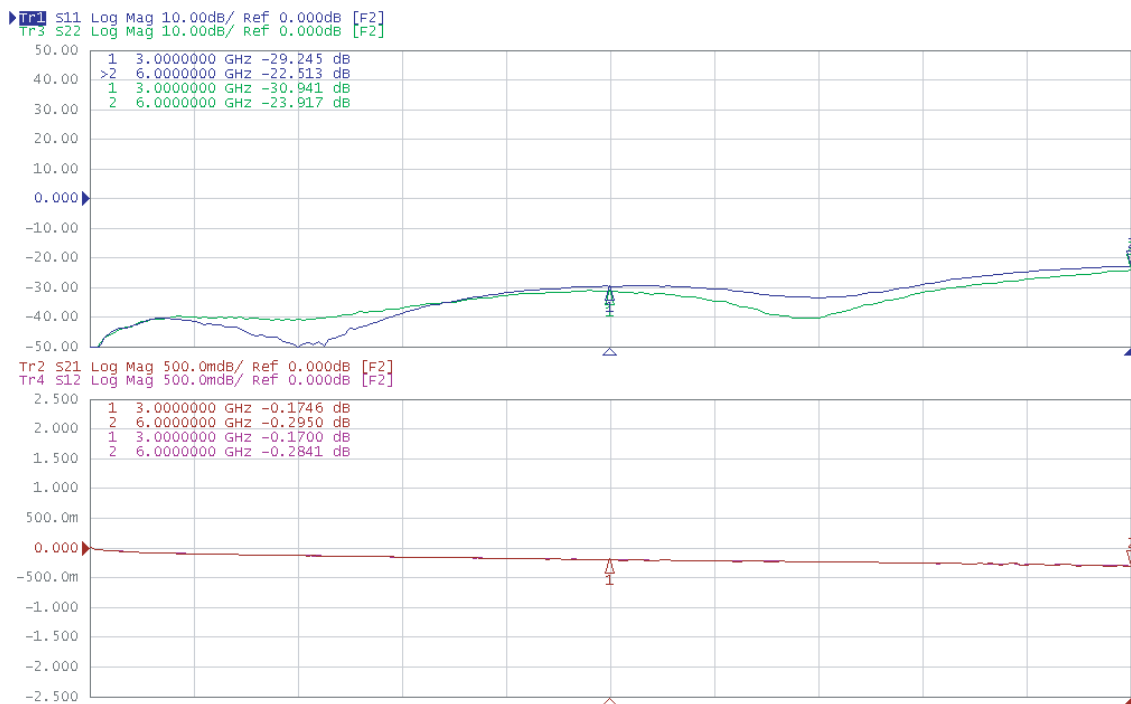

**RAPIDTEK**  
**RF PROBE**

LIFE REPORT

Lab Environmental Condition :

Temperature : 25±5°C

Relative Humidity : ≤ 50 % RH

Test Specification : 12 Times / Minute

Test Method : Compression 1.0mm ± 0.1mm

Durability : 12,000 cycles



Insert & Withdrawal Equipment

Result :

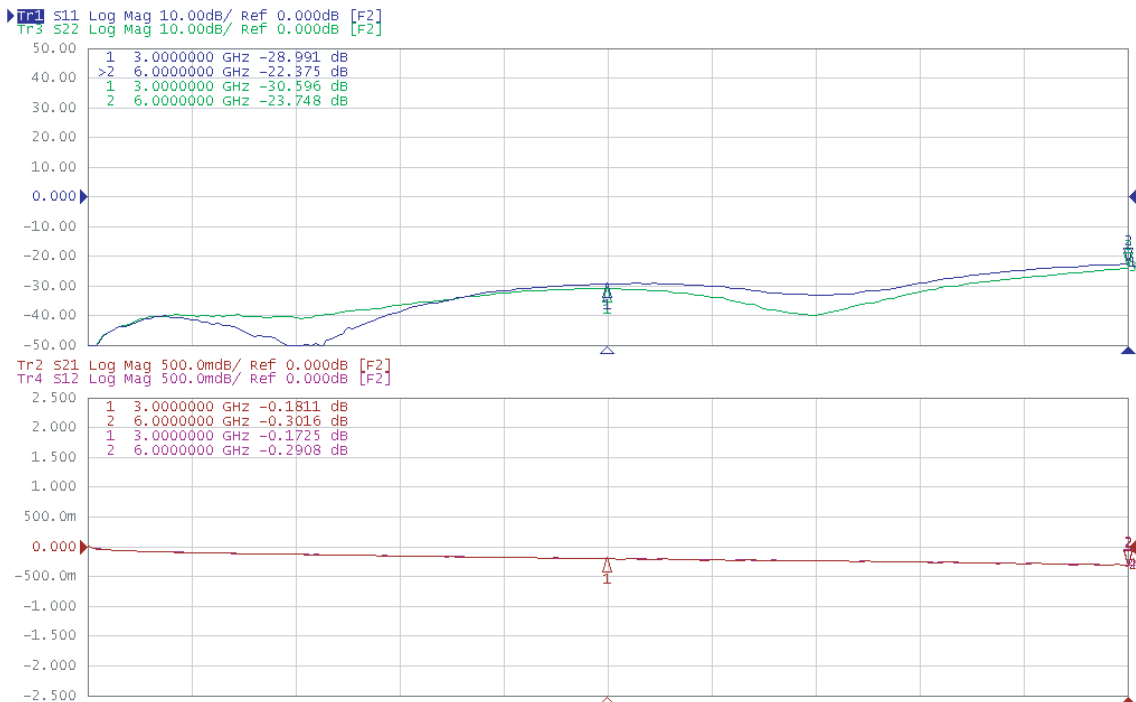

RAPIDTEK  
RF PROBE