



Data-Sheet-Fixed Capacitor

CKT200/17.5/143



www.glvac.com

Specification	
Capacity C_{max} (nominal)	200pF
Voltage (Peak Test U_{pt} /Peak Working U_{pw})	25kV/15kV
Capacity tolerance	5%
Max. Current I_{max} at 13.56MHz with	143Arms
Conduction Cooling	50W
Net Weight	0.52kg

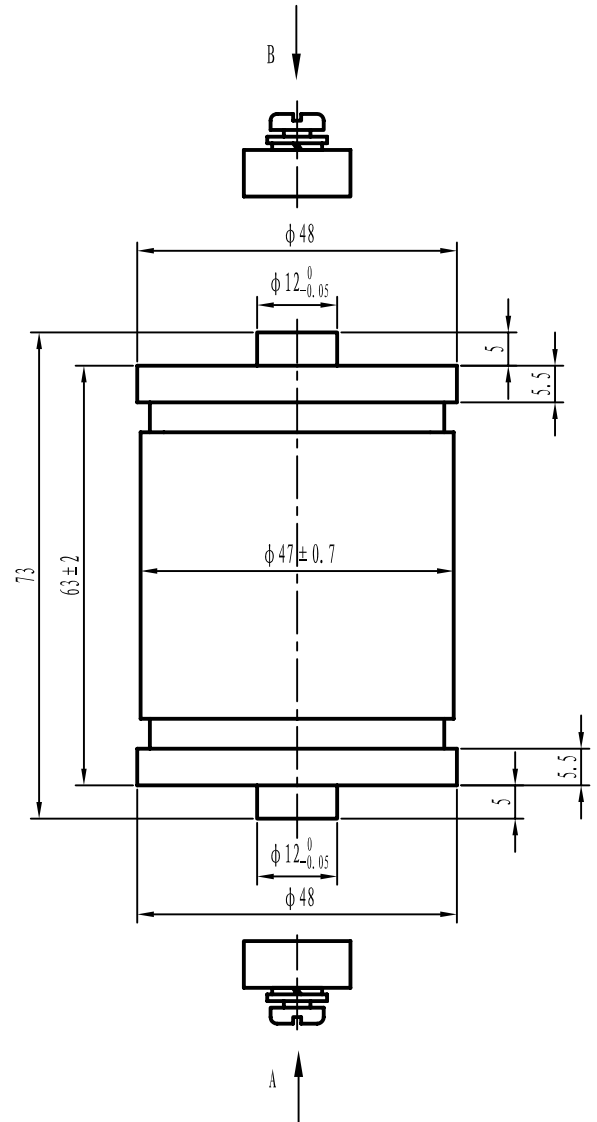

I_{max} at 25 °C ambient and 125 °C surface for convection and conduction (50w) cooling

