

## SMA (M) TO SMA (M) CABLE

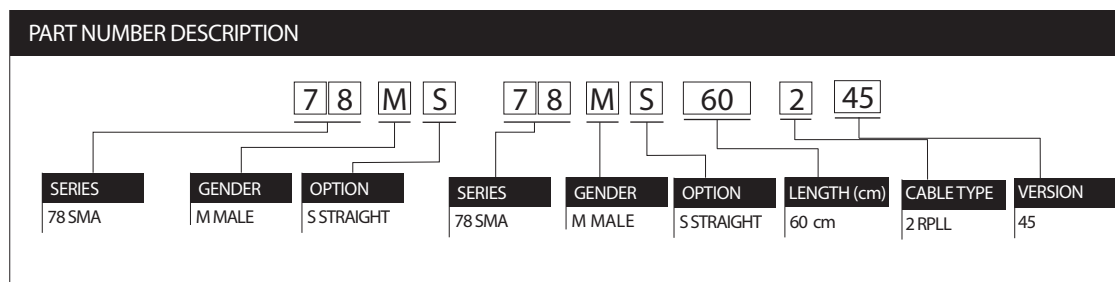

**MATERIAL AND FINISH**

	DETAIL
CABLE	RPLL
CONNECTOR A	SMA MALE
CONNECTOR B	SMA MALE

**MECHANICAL AND ENVIRONMENTAL**

	SPECIFICATIONS
NOMINAL OUTER DIAMETER	2.64 mm
MIN BEND RADIUS	12.7 mm
TEMPERATURE RANGE	-55 °C ~ 155 °C
GOLD THICKNESS	10um MAX.

**ELECTRICAL**

	TEST CONDITION	SPECIFICATIONS
IMPEDANCE	DC~ 18 GHz	50 Ohms
VSWR	DC~ 18 GHz	1.3 Max
INSERTION LOSS	DC~ 18 GHz	3.6 dB Max
INSULATION	DC~ 18 GHz	≧ 90dB



**RAPIDTEK**  
RF COAXIAL CABLE

Rapidtek Magnetic Devices Inc.  
<http://www.rapidtek.net>  
 Tel : 02 - 8698 - 1068  
 Fax : 02 - 8698 - 1018  
 17F, No.75, Sec. 1, Xintai 5th Rd., Xizhi Dist., New Taipei City 22101, Taiwan

### STANDARD DIMENSIONS

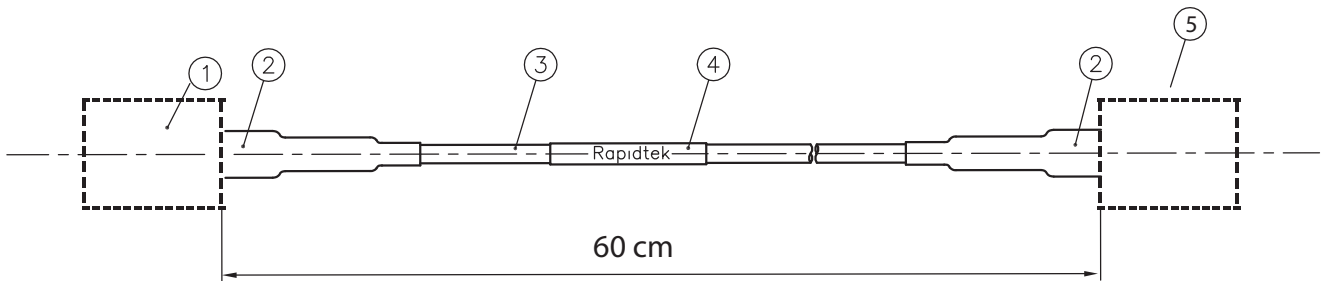

- 1 SMA (M) CONNECTOR
- 2 HEAT SHRINK TUBE
- 3 CABLE
- 4 LABEL
- 5 SMA (M) CONNECTOR

### CABLE

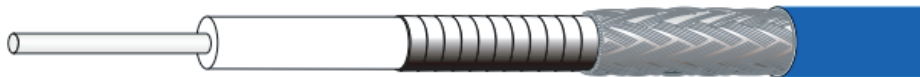

Connector parts	Material	Diameter
Inner Conductor	Copper Silver plated	0.51 mm
Dielectric	PTFE	1.63 mm
Foil	Copper Silver plated	1.80 mm
Braid	Copper Silver plated	2.18 mm
Jacket	FEP	2.64 mm

### CONNECTOR

SMA PLUG

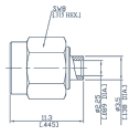

SMA PLUG 90°

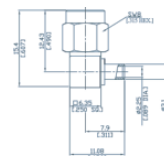

N

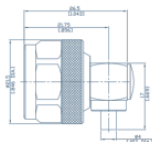

SMP female



SMP female 90°

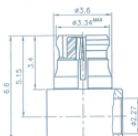

**RAPIDTEK**  
RF COAXIAL CABLE

Rapidtek Magnetic Devices Inc.  
<http://www.rapidtek.net>  
 Tel : 02 - 8698 - 1068  
 Fax : 02 - 8698 - 1018

17F, No.75, Sec. 1, Xintai 5th Rd., Xizhi Dist., New Taipei City 22101, Taiwan (R.O.C.)