

## SMA (M) TO SMA (M) CABLE

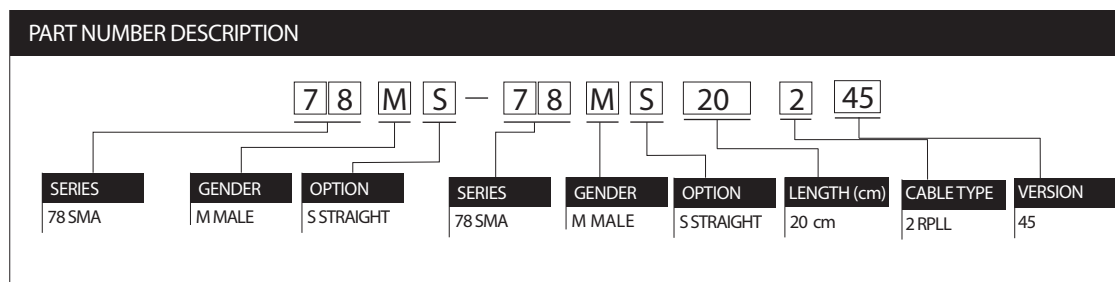

**MATERIAL AND FINISH**

	DETAIL	Material
CABLE	RPLL	RPLL
CONNECTOR A	SMA MALE	CENTER CONTACT (FINISH 10um MAX GOLD) OUTER CONTACT (STAINLESS STEEL)
CONNECTOR B	SMA MALE	CENTER CONTACT (FINISH 10um MAX GOLD) OUTER CONTACT (STAINLESS STEEL)

**MECHANICAL AND ENVIRONMENTAL**

	SPECIFICATIONS
NOMINAL OUTER DIAMETER	2.64 mm
MIN BEND RADIUS	12.7 mm
TEMPERATURE RANGE	-55 °C ~ 155 °C

**ELECTRICAL**

	TEST CONDITION	SPECIFICATIONS
IMPEDANCE	DC~ 18 GHz	50 Ohms
VSWR	DC~ 18 GHz	1.4 Max
INSERTION LOSS	DC~ 18 GHz	1.2 dB Max
RF LEAKAGE	DC~ 18 GHz	-90 dB
VELOCITY OF SIGNAL PROPAGATION		70%
DELAY TIME		4.72 ns/m



**RAPIDTEK**  
**RF COAXIAL CABLE**

Rapidtek Magnetic Devices Inc.  
<http://www.rapidtek.net>  
 Tel : 02 - 8698 - 1068  
 Fax : 02 - 8698 - 1018  
 17F, No.75, Sec. 1, Xintai 5th Rd., Xizhi Dist., New Taipei City 22101, Taiwan

### STANDARD DIMENSIONS

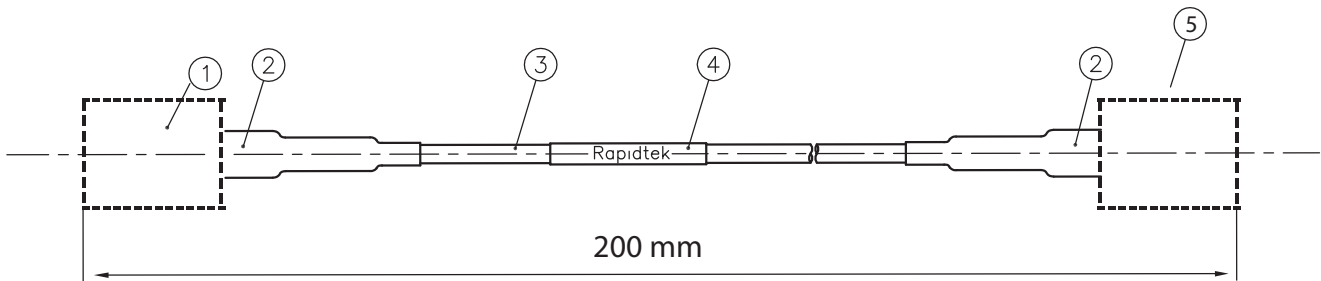

- 1 SMA (M) CONNECTOR
- 2 HEAT SHRINK TUBE
- 3 CABLE
- 4 LABEL
- 5 SMA (M) CONNECTOR

### CABLE

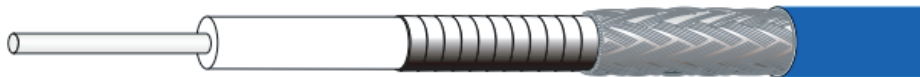

Connector parts	Material	Diameter
Inner Conductor	Copper Silver plated	0.51 mm
Dielectric	PTFE	1.63 mm
Foil	Copper Silver plated	1.80 mm
Braid	Copper Silver plated	2.18 mm
Jacket	FEP	2.64 mm

### CONNECTOR

SMA PLUG

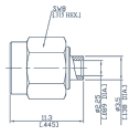

SMA PLUG 90°

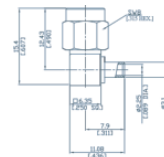

N

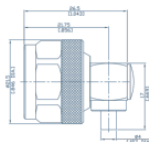

SMP female



SMP female 90°

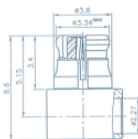

**RAPIDTEK**  
**RF COAXIAL CABLE**

Rapidtek Magnetic Devices Inc.  
<http://www.rapidtek.net>  
Tel : 02 - 8698 - 1068  
Fax : 02 - 8698 - 1018

17F, No.75, Sec. 1, Xintai 5th Rd., Xizhi Dist., New Taipei City 22101, Taiwan